

# Nxtwall Installation Instruction

## Installation Scenario:

### View Series Single Sidelight

- This guide covers how to install the framing and glass for this scenario.

## Nxtwall Components Covered by this Instruction:

- View Wall-Start
- View Track
- View Guide
- View L-Bracket
- Leveling Bolts
- Track Glass Channel

## Recommended Installation Tools:

- Miter Saw
- Laser Level (or Level)
- Tape Measure
- Impact Driver and/or Drill
- Nylon Mallet/Rubber Mallet
- Phillips Screwdriver
- Utility Knife
- Hammer Drill
- External Attaching Hardware
  - Note: Nxtwall does not include external attaching hardware.
- Glass Suction Cup

## Single Sidelight Defined

A Single Sidelight in the View Series is when there is a single piece of glass between two View Wall-Starts. The “Glass Side” of the Wall-Starts will be facing each other. Fig. 1.

Fig. 1

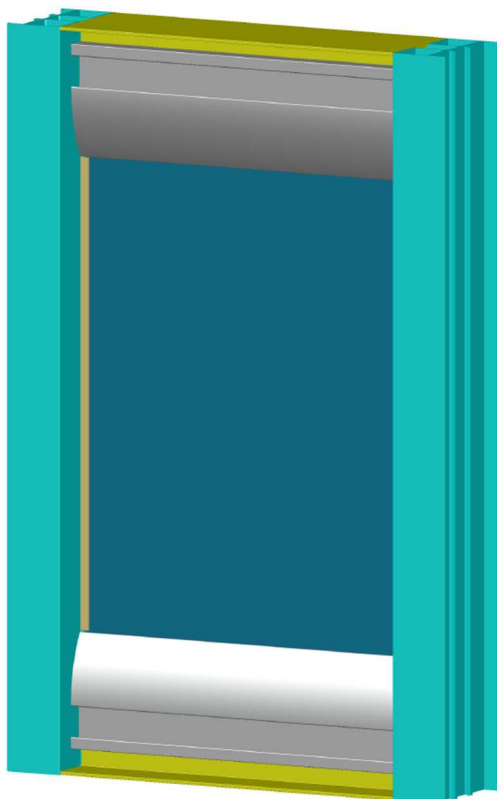

View Wall-Start

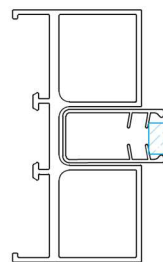

View Wall-Start

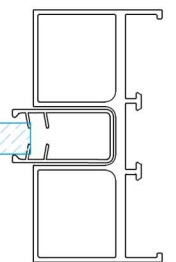

Single Piece of Glass

# Nxtwall Installation Instruction

## Single Sidelight Defined

Single Sidelights can occur in different scenarios. Typically, they are found in Swing Door or Sliding Door situations.

- Swing Doors (Fig. 2)
- Sliding Doors (Fig. 3)

Other situations include between existing walls, between Flex Posts, etc. Again, it is any time there are two Wall-Starts with the “Glass Side” facing each other.

Fig. 2



Fig. 3

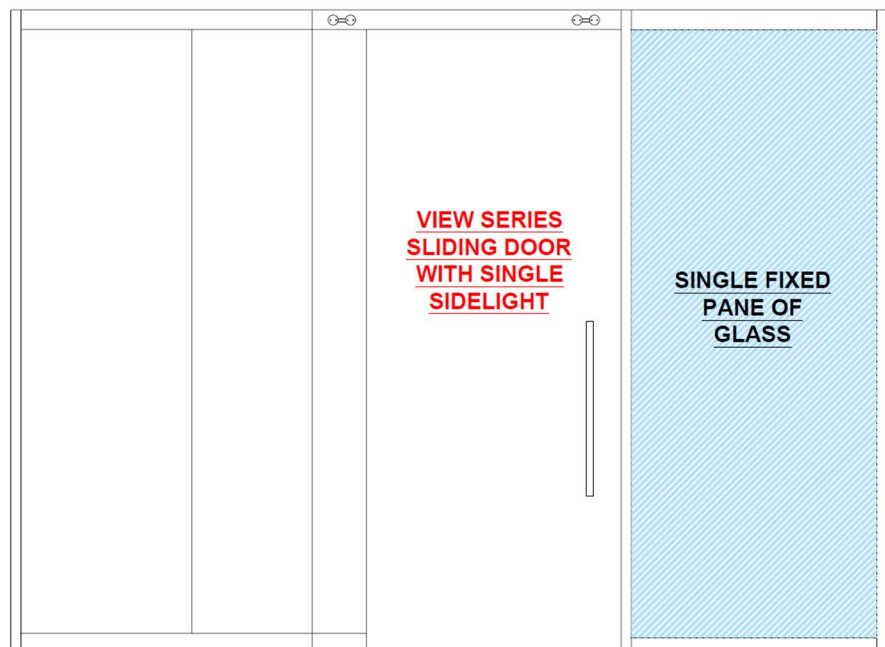

# Nxtwall Installation Instruction

## Single Sidelight Installation

The order in which the framing is installed for Single Sidelight situations will remain the same as if there are multiple panes of glass. For detailed information on framing reference the installation guides pertaining to the installation situation.

For Single Sidelights there are two main differences in the installation procedure each to be covered in this guide.

1. The profile of the glass channel used in the Wall-Start will be different than a partition with multiple panes of glass.
2. The glass will be measured differently for Single Sidelights.

## Installation Procedure

1. Install all framing.
  - a. Install the "View Track Glass Channel" profile into the View Track. Include 3/4" Shims in the View Track on the floor. Fig. 4.
  - b. **Do not install** the "Wall-Start Glass Channel" profile into the Wall-Starts.
2. For Single Sidelights the "View Track Glass Channel" profile will be used in both the View Track and the Wall-Starts. Fig. 5 and 6.
  - a. This is related to how the glass will be measured for and installed.
3. Do not install the View Track Glass Channel into the Wall-Starts. The Glass Channel will be installed once the glass has been received.

Fig. 4

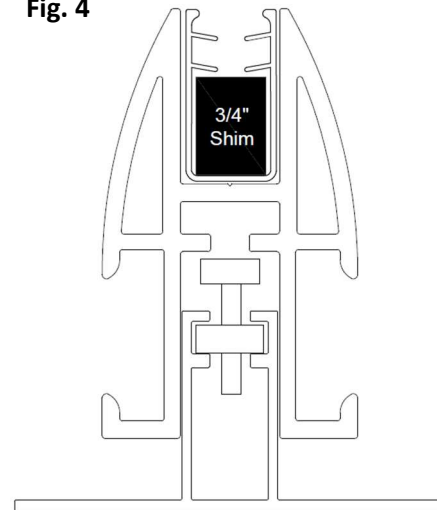
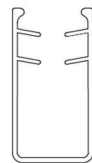
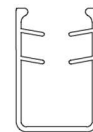

Fig. 5



View Track  
Glass Channel



View Wall-Start  
Glass Channel

**NOT USED for Single Sidelights**

Fig. 6

View Wall-Start

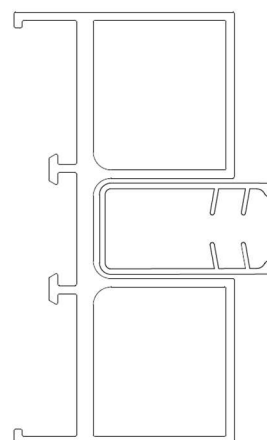

Track Glass Channel

# Nxtwall Installation Instruction

4. Measure Glass for the Single Sidelight.
  - a. **Single Sidelight Width Measurement: Visual Opening – 1/8" (Fig. 7)**
  - b. **Single Sidelight Height Measurement: Visual Opening + 1" (Fig. 8)**
  - c. Note: The width measurement for Single Sidelights is different than the width measurement for Partitions with multiple panes of glass.
5. The width of the glass will be slightly smaller than the visual opening. The View Track Glass Channel will be used to cover the vertical edges of the glass.
  - a. Make sure the opening is as square as possible.
6. Once the glass has been received measure and cut the View Track Glass Channel for the Wall-Starts.
  - a. Measurement is the visual opening between the floor and ceiling View Track.

Fig. 8

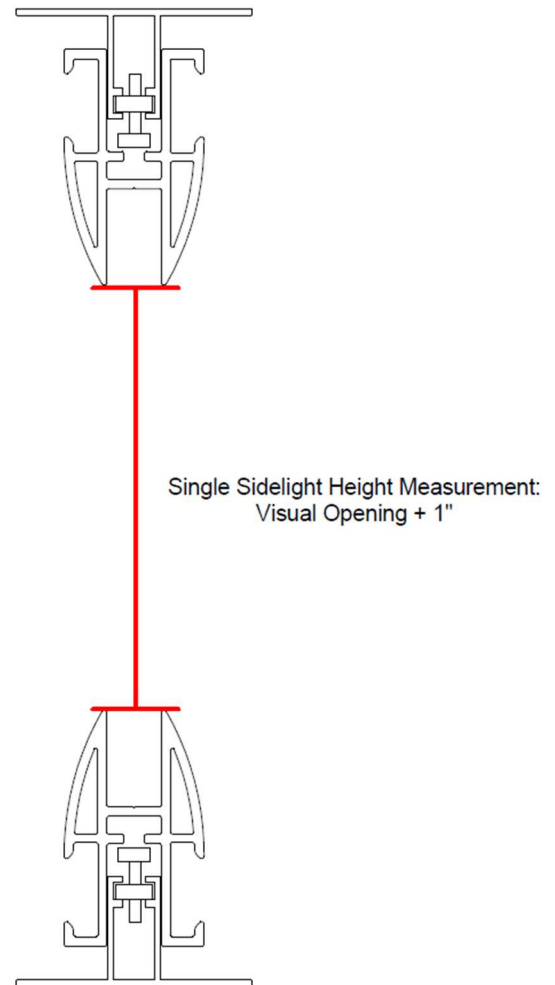
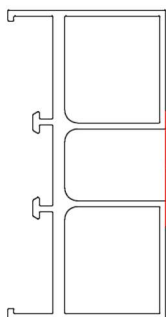
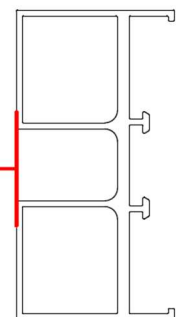

Fig. 7

View Wall-Start



View Wall-Start



Single Sidelight Width Measurement:  
Visual Opening - 1/8"

# Nxtwall Installation Instruction

7. Install the glass into the opening. Fig. 9.
  - a. To install the glass, lift the glass into the ceiling track first. Then, bring the glass over the floor track. Lastly, place the glass on the shims in the floor track.
  - b. To assist with the installation of the glass spray glass cleaner onto the glass channel to act as a lubricant between the glass and the glass channel.
8. Slide the glass into one of the Wall-Starts. This creates a gap to give the ability to install the Glass Channel into the Wall-Start. Fig. 10.
9. Remove the backing tape from the View Track Glass Channel for the Wall-Start.
10. Insert the Glass Channel into the Wall-Start. Fig. 10.
  - a. Use a long object to press the Glass Channel into the Wall-Start adhering the backing tape to the inside of the Wall-Start.

Fig. 9

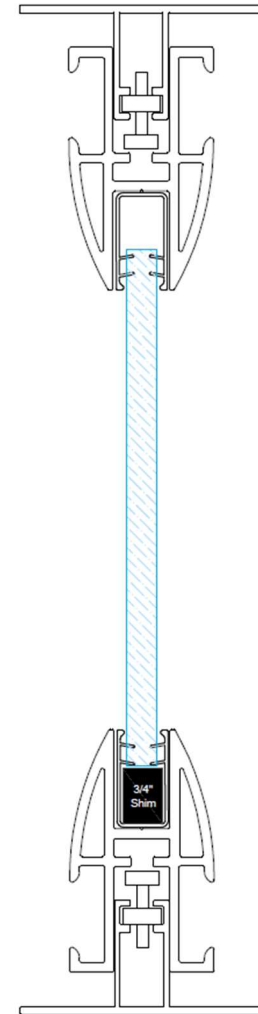
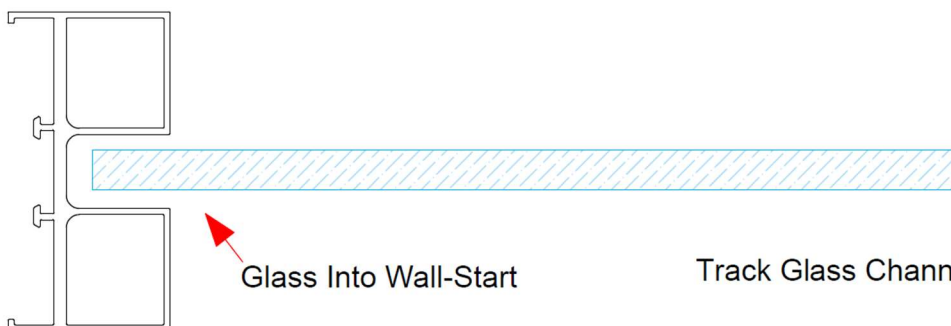

Fig. 10

View Wall-Start



Track Glass Channel

View Wall-Start

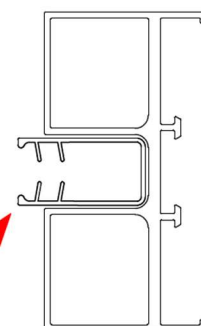

# Nxtwall Installation Instruction

11. Slide the glass into the Glass Channel/Wall-Start. Fig. 11.
  - a. Use glass cleaner as lubricant to help slide the glass.
12. Install View Track Glass Channel into the Wall-Start on the opposite side. Fig. 11.
  - a. Make sure to remove the backing tape from the Glass Channel.
13. Center the glass within the opening. The vertical edges of the glass should be covered by the Glass Channel. Fig. 12.
14. Installation complete.

Fig. 11

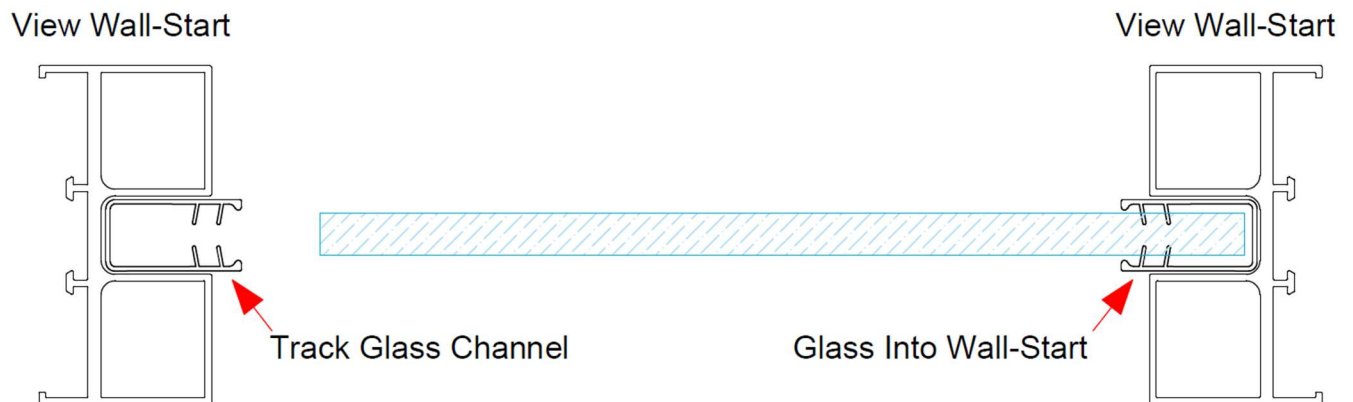

Fig. 12

